

The **My Open Library service** offers extended opening hours by providing library access to My Open Library members from 8am to 10pm every day. Staffed hours continue on the normal schedule. You must be 16 or over to register for this service. Under 16s can access only with a parent or guardian.



Entering the library



1. You must have your library card and PIN.
2. Scan your card under the barcode reader beside the front door. The barcode must be facing up and the numbers facing in. When you hear a beep, enter your PIN.
3. **The door will open automatically for 15 seconds. Wait inside the library building until the door has closed. It is your responsibility not to let anyone else in on your entry.**
4. The door will open automatically to allow you to exit.

THE LIBRARY IS MONITORED BY CCTV AT ALL TIMES.

The emergency exit at the side of the building close to the public toilet area is alarmed and should be opened in the event of an emergency. Access to other parts of the building is prohibited and doors are alarmed.

Entering the toilet



- You must have your library card.
- Scan your card under the barcode reader beside the door. The barcode must be facing up and the numbers facing in.
- Pull open the door. Manually lock the door behind you.
- To exit, unlock the door and press the switch beside the door to open.
- In case of emergency, pull the red emergency cord near the toilet.

Closing time



The library closes at 10pm sharp. Please follow the audio instructions and leave the library on time. The intruder alarm will set automatically at closing time. Anyone remaining in the library after 10pm will activate the alarm, alerting the security company.

Emergency Procedure



If there is a fire alarm or power cut, please leave the library through the nearest emergency exit. A fire alarm will trigger flashing beacon lights in the building and a siren.

There are 2 emergency exits (as shown on the map):

- One at the back of the building close to the public toilet area.
- One through the main front automatic door



The assembly point is at the top end of the public library car park .

If you feel unsafe in the library, or someone follows you in without using their card and pin:



Use the intercom to contact the monitoring company.

Use your mobile phone to contact the monitoring company on 0818 313 300 or 045 408300

In the case of an emergency use your mobile phone to call 999 for emergency services.

The eircode is Y34 NW56.

Address: New Ross Library, Barrack Lane, New Ross, Co. Wexford.

A First Aid box is on the wall near the library desk.



New Ross

Phone: 051 421 877

Email: myopenlibrarynewross@wexfordcoco.ie







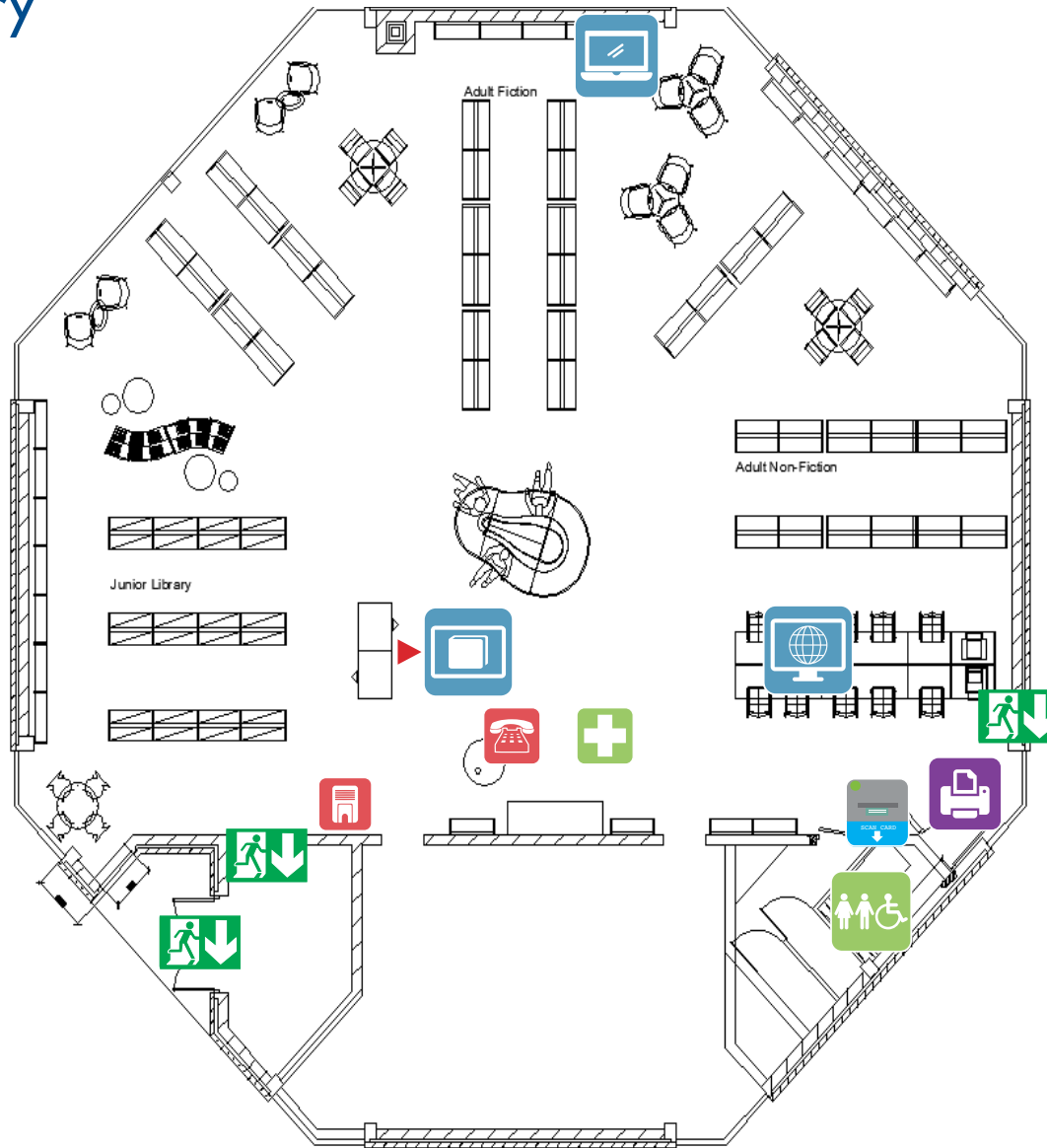

Comhairle Contae
Loch Garman
Wexford
County Council

New Ross Library Floor Plan



Map Key

-  Barcode reader and pin keypad
-  Barcode reader
-  Toilets
-  First aid box
-  Intercom
-  Emergency services
-  Fire exit

My Open Library services

-  "Print Copy & Go" self-service printing, copying & scanning
-  Wi Fi network
-  Library self service machines
-  Computers
-  Self-service laptops

Day	Staffed Hours	My Open Library Hours
Monday	10.30am-1.00pm 2.00pm-5.30pm	8.00am-10.30am 1.00pm-2.00pm 5.30pm-10.00pm
Tuesday	10.30am-8.30pm	8.00am - 10.30am 8.30pm - 10.00pm
Wednesday	10.30am-5.30pm	8.00am-10.30am 5.30pm-10.00pm
Thursday	10.30am-5.30pm	8.00am-10.30am 5.30pm-10.00pm
Friday	10.30am-5.30pm	8.00am-10.30am 5.30pm-10.00pm
Saturday	10.30am-1.00pm 2.00pm-5.30pm	8.00am-10.30am 1.00pm-2.00pm 5.30pm-10.00pm
Sunday	No Staff	8.00am -10.00pm

Please ask library staff for further information