

Copyright. All Rights Reserved.
This work is copyright and cannot be produced or copied in any form or by any means (graphic, electronic or mechanical including photocopying) without the written permission of the originator. Any reuse, express or implied, to use this document for any purpose whatsoever is restricted to the terms of the agreement or implied agreement between the originator and the instructing party.

Levels and contours are relative to an Ordnance Survey Datum
Figured dimensions in millimetres.

- NOTES:**
1. Trinity Wharf site information (existing levels and materials etc) from Cardinal Surveys Drawing Ref: 19-125-02
 2. ITM coordinates E705520, N621320
 3. Ordnance Survey Ireland License No AR 009418 © Government of Ireland OS Map Sheet reference numbers: 5451-23, 5451-22
- Levels and contours are relative to Main Head Ordnance Datum

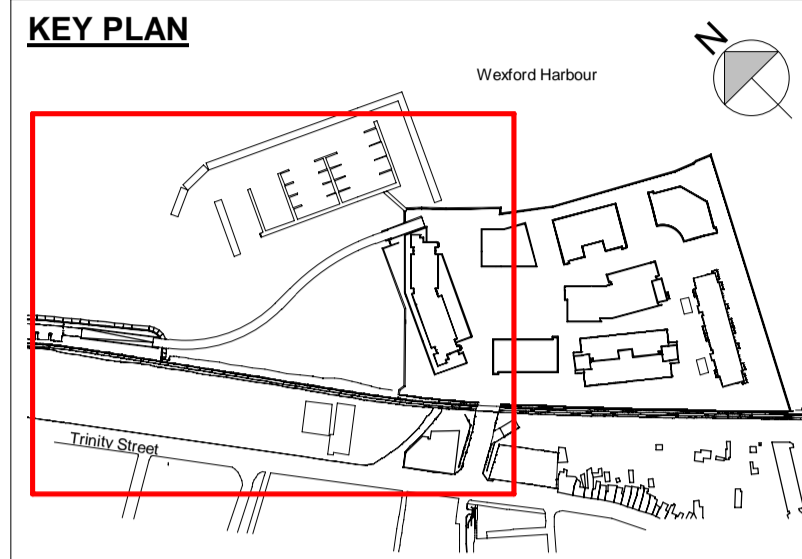

- KEY:**
- APPLICATION SITE OUTLINED IN RED (TOTAL AREA: 55,000m²; 5.5 Ha approx)
 - ADJACENT LANDS IN CONTROL OF THE APPLICANT OUTLINED IN BLUE

REVISION SCHEDULE		
NO.	DATE	DESCRIPTION
P01	2019.02.07	Issued for Planning

**Mixed Use Development
Trinity Wharf Wexford**

CLIENT
Wexford County Council
County Hall, Carricklagan, Wexford.
Y55 WY93
Tel: 053 919 6000
Web: www.wexfordcoco.ie



STW
Scott Tallon Walker
ARCHITECTS
19 Merrion Square, Dublin 2, Ireland
Tel: +353 (0)1 669 3000
Email: mail@stwarchitects.com
Web: www.stwarchitects.com

PROPOSED SITE LAYOUT - SITE DIMENSIONS - PAUL QUAY & BOARDWALK

SCALE @A1	ISSUED:
As indicated	2019.02.07
DRAWN BY:	CHECKED BY:
TH	PJ
PROJECT NO.	PROJECT ARCHITECT:
15058	Philip Jackson
DRAWING NO.	REVISION
TWW-STW-00-ZZ-DR-A-131-2014	P01

PROJECT STAGE: **Stage 4: PLANNING APPLICATION**
07/02/19 3:34:22 PM TWW-STW-00-ZZ-M3-A-0000_SHEETS

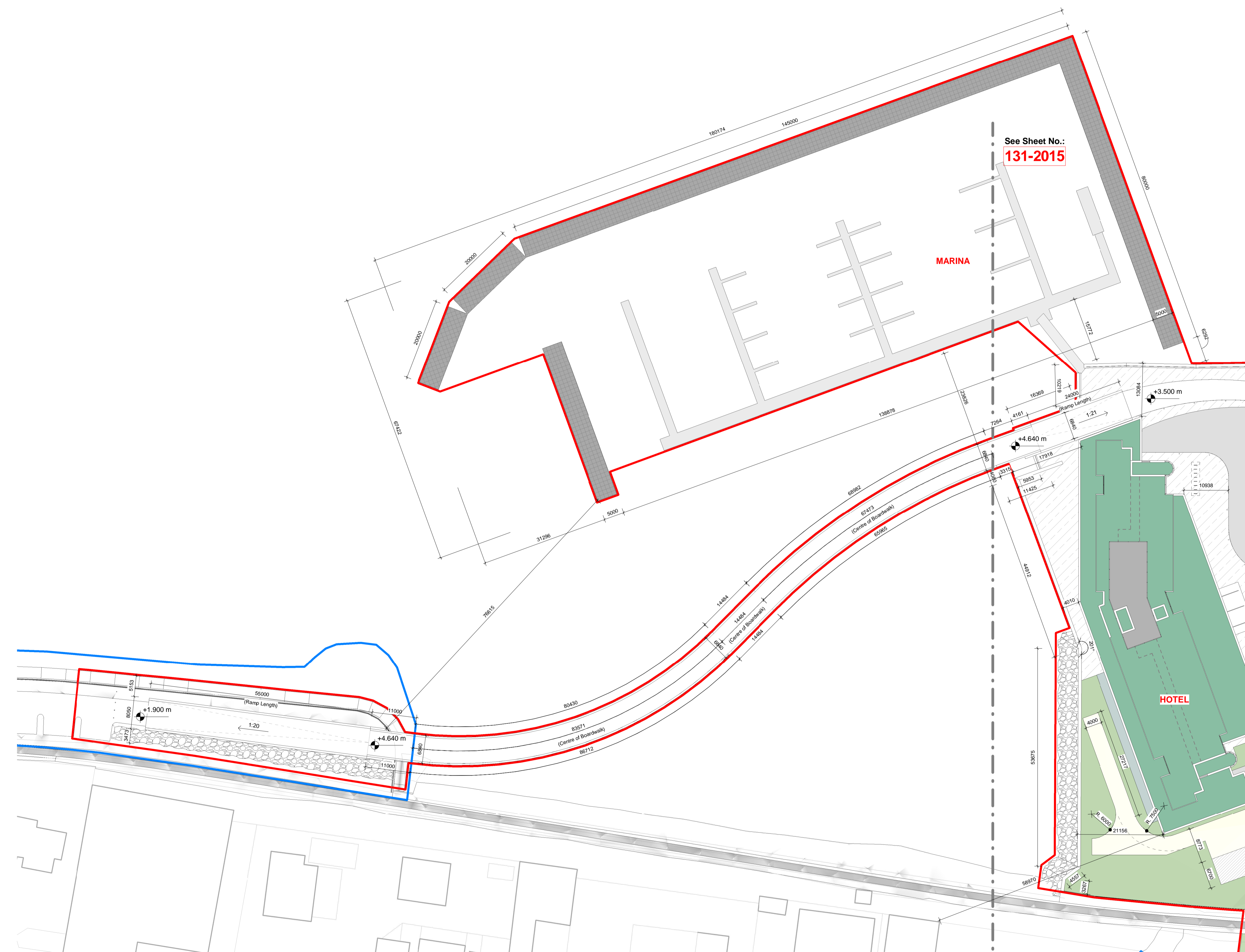

1-PROPOSED SITE LAYOUT - SITE DIMENSIONS - PAUL QUAY & BOARDWALK

1 : 500

See Sheet No.:
131-2015

MARINA

HOTEL

1-PROPOSED SITE LAYOUT - SITE DIMENSIONS - PAUL QUAY & BOARDWALK

1 : 500