

1-CARPARK PLANT
1 : 200

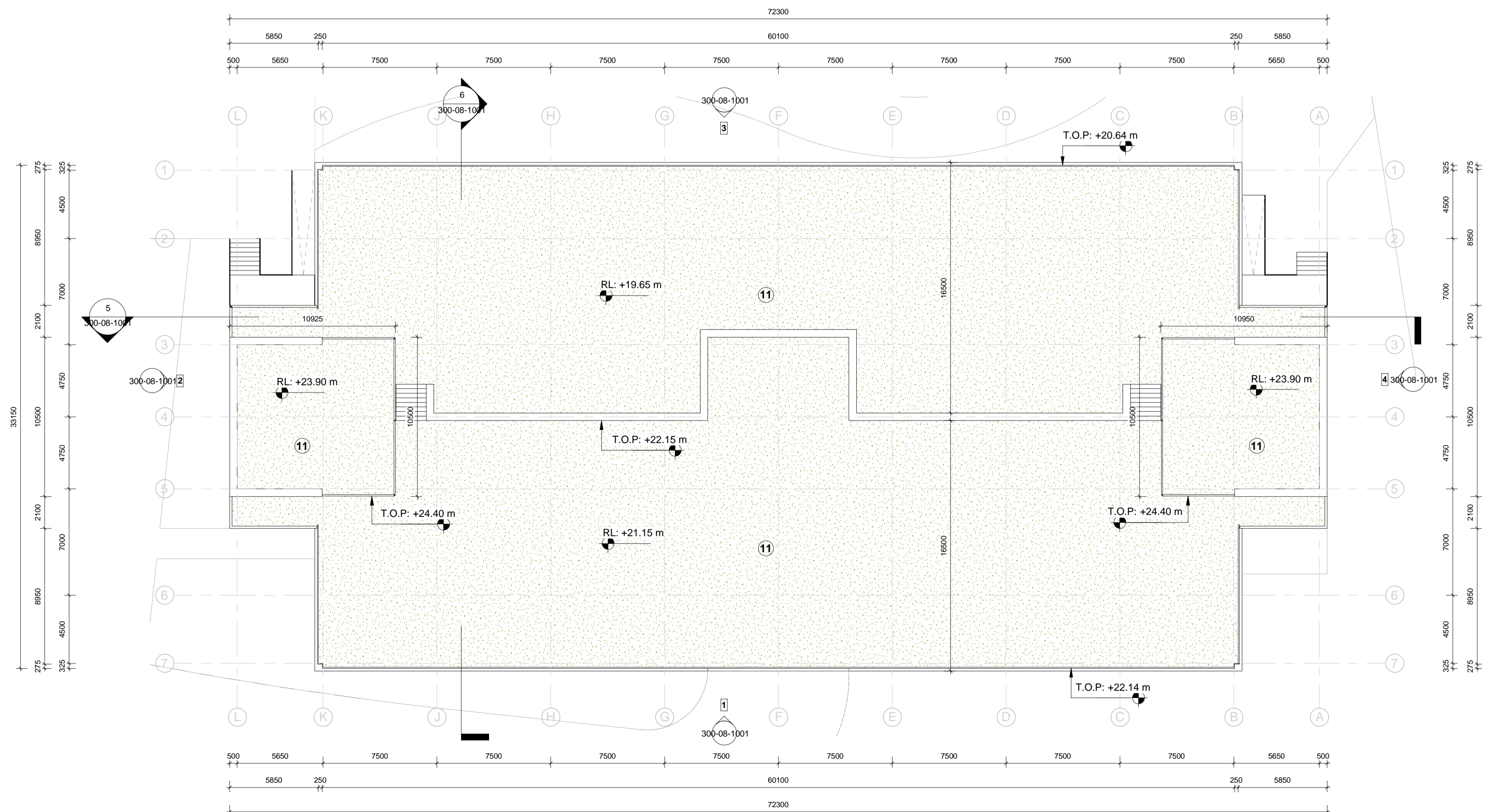

2-CARPARK ROOF
1 : 200

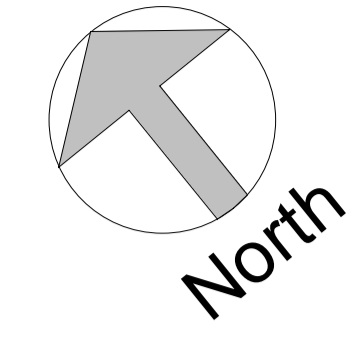

Copyright. All Rights Reserved.
This work is copyright and cannot be produced or copied in any form or by any means (graphic, electronic or mechanical including photocopying) without the written permission of the originator. Any reuse, express or implied, to use this document for any purpose whatsoever is restricted to the terms of the agreement or implied agreement between the originator and the instructing party.

Levels and contours are relative to an Ordnance Survey Datum
Figured dimensions in millimetres.

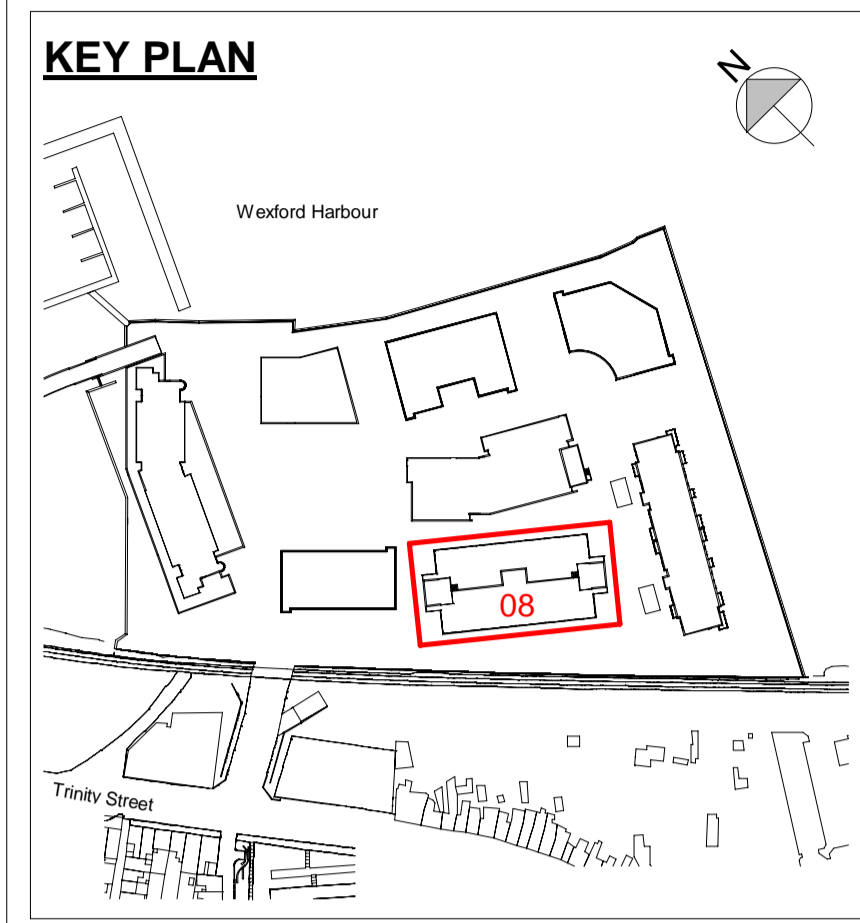

| 08_CarPark - Gross Floor Area (GFA) | |
|-------------------------------------|----------------------------|
| Level | Area |
| CARPARK LEVEL 00_A_LG | 979 m ² |
| CARPARK LEVEL 00_B_G | 1059 m ² |
| CARPARK LEVEL 01_A | 1059 m ² |
| CARPARK LEVEL 01_B | 1053 m ² |
| CARPARK LEVEL 02_A | 1053 m ² |
| CARPARK LEVEL 02_B | 1053 m ² |
| CARPARK LEVEL 03_A | 1053 m ² |
| CARPARK LEVEL 03_B | 1053 m ² |
| CARPARK LEVEL 04_A | 1053 m ² |
| CARPARK LEVEL 04_B | 1053 m ² |
| CARPARK LEVEL 05_A | 1053 m ² |
| CARPARK LEVEL 05_B | 1053 m ² |
| CARPARK_Roof (Lower) | 176 m ² |
| TOTAL GROSS AREA: | 12752 m² |

| EXTERNAL FINISHES LEGEND | |
|--------------------------|--|
| Key | Description |
| 1 | Selected Reconstituted Stone |
| 2 | Glazing with Aluminium Mullions (PPC - RAL 7006) |
| 3 | Glazing with Aluminium Mullions and Louvre System (PPC - RAL 7006) |
| 4 | Glazing with Aluminium Mullions, Louvre System and Brise Soleil (PPC - RAL 7006) |
| 5 | Glazed Railing to Balconies |
| 6 | Aluminium Perforated Panels to Carpark (RAL 8001) |
| 7 | Pressed Metal Parapet Capping |
| 8 | Aluminium Louvre Panels (RAL 7006) |
| 9 | Aluminium Panels (RAL 7006) |
| 10 | Roof Mounted Photovoltaic (PV) Panels |
| 11 | Planted Sedum Roof |

| REVISION SCHEDULE | | |
|-------------------|------------|---------------------|
| NO. | DATE | DESCRIPTION |
| P01 | 2019.02.07 | Issued for Planning |
| | | |
| | | |
| | | |
| | | |
| | | |

Mixed Use Development
Trinity Wharf Wexford

CLIENT
Wexford County Council
County Hall, Carricklawn, Wexford.
Y35 WY93
Tel: 053 919 6000
Web: www.wexfordcoco.ie



STW
Scott Tallon Walker
ARCHITECTS
19 Merrion Square, Dublin 2, Ireland
Tel: +353 (0)1 669 3000
Email: mail@stwarchitects.com
Web: www.stwarchitects.com

DRAWING
CARPARK_PLANS_SHEET 4 OF 4

| | |
|--|--------------------------------------|
| SCALE @A1 1 : 200 | ISSUED: 2019.02.07 |
| DRAWN BY: TH | CHECKED BY: PJ |
| PROJECT NO. 15058 | PROJECT ARCHITECT: Philip Jackson |
| DRAWING NO. TWW-STW-00-ZZ-DR-A-200-08-1004 | REVISION P01 |