

Wexford to Curracloe Greenway

Standard Details



Book No.4



Wexford to Curracloe Greenway

Standard Details

This project is funded by Wexford County Council.

This report was prepared by: Rory O'Mahony, BSc. (Eng), C. Eng.

Revision:	Description:	Prepared by:	Checked by:	Approved by:	Issue Date:
1	Issue Copy	rom	gp	gf	23-Feb-18

Book No.4	Standard Trail Details:
------------------	--------------------------------

Trail Construction Details

No.	Description:	Scale:	Rev:
TCD/100/01	Typical Trail Cross Section (3m wide)	NTS	Jan 2017
TCD/100/02	Minimum Trail Cross Section (2.5m wide)	NTS	Jan 2017
TCD/100/05	Typical Screening (Residential)	NTS	Jan 2017
TCD/100/06	Typical Screening (Wildlife)	NTS	Jan 2017
TCD/100/07	Trail Crossing at Minor Road	NTS	Jan 2017
TCD/200/05	Mammal Pass	NTS	Jan 2018
TCD/300/01	Dog Proof Narrow Gauge Fence (1.4m high)	NTS	Jan 2017
TCD/300/05	Timber Cladding Screen (1.8m - 2.4m high)	NTS	Jan 2017
TCD/300/06	Staggered Trail Gates	NTS	Jan 2017
TCD/300/07	Paladin Metal Fence (1.8m high)	NTS	Jan 2017
TCD/500/02	Precast Concrete Box Culvert	NTS	Jan 2017
TCD/700/04	Macadam Pavement	NTS	Jan 2017
TCD/1000/03	Raised Deck Viewing Platform	NTS	Jan 2017

Road Construction Details

No.	Description:	Scale:	Rev:
NRA RCD/300/11	Timber Single Field Gate	NTS	Jan 2017
NRA RCD/300/09	Steel Single Field Gate	NTS	Jan 2017
NRA RCD/1200/01	Demountable Bollard	NTS	Jan 2017

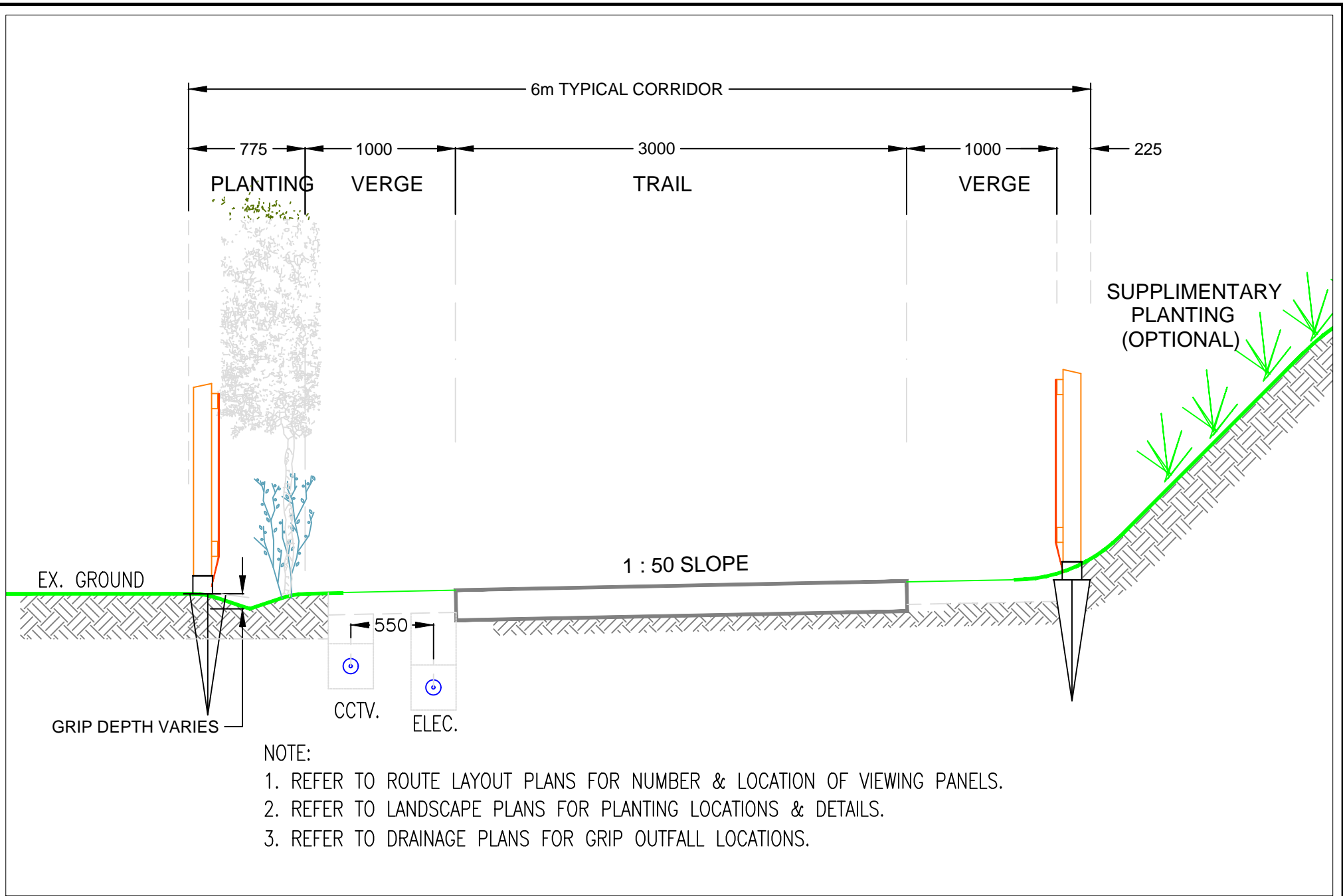

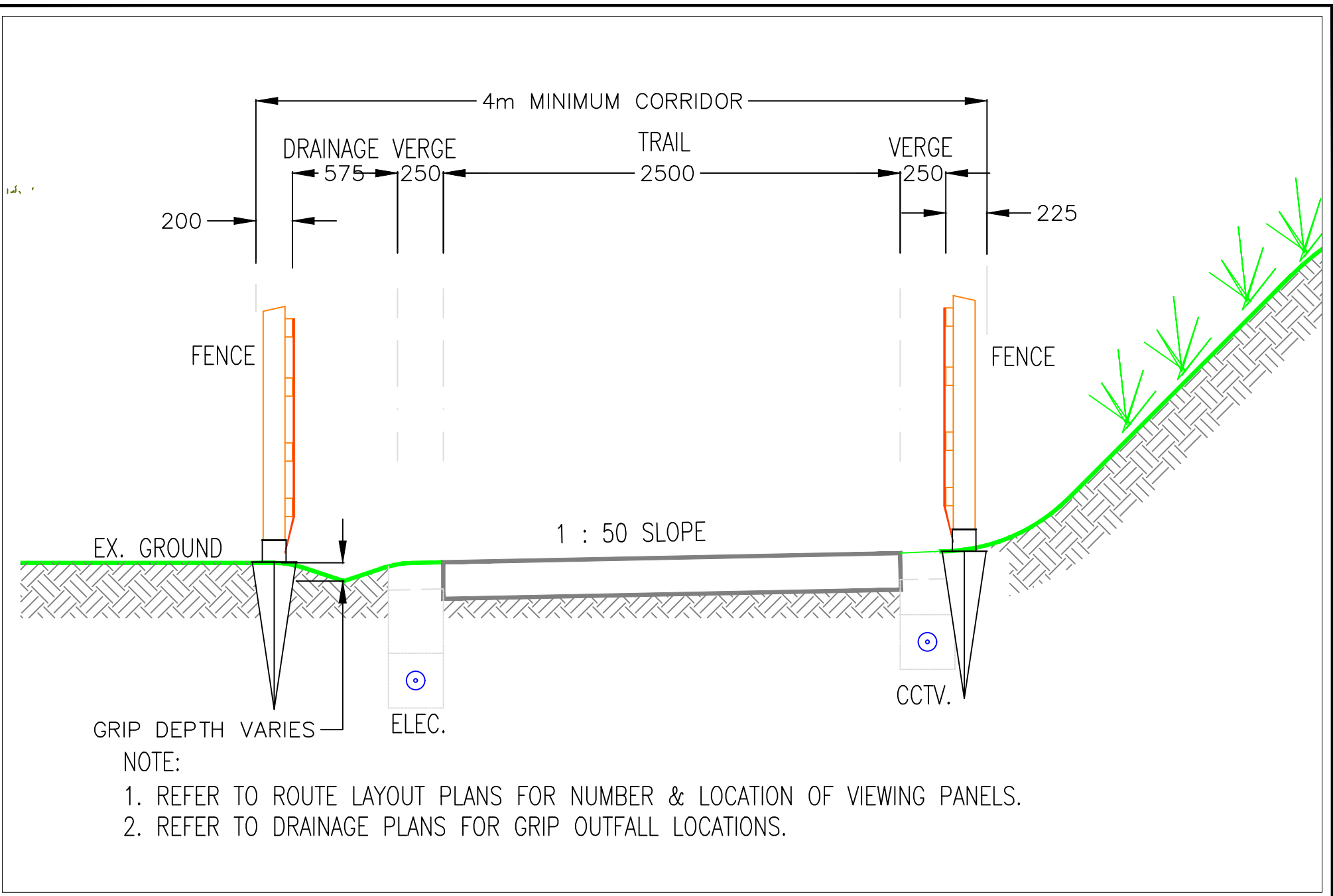

WEXFORD COUNTY COUNCIL 	<small>WEXFORD COUNTY COUNCIL COUNTY HALL GARIBOLDINI WEXFORD TEL: 053 919550</small>	<small>DRAWING REFERENCE</small> TCD/100/02	<small>DRAWING TITLE</small> MINIMUM TRAIL CROSS SECTION (2.5M WIDE)	<small>SERIES TITLE</small> TRAIL CROSS -SECTIONS & LAYOUTS	<small>DRAWN:</small> R O'MAHONY
				<small>SCALE:</small> DO NOT SCALE	<small>CHECKED:</small> <small>DATE:</small> JAN 2017

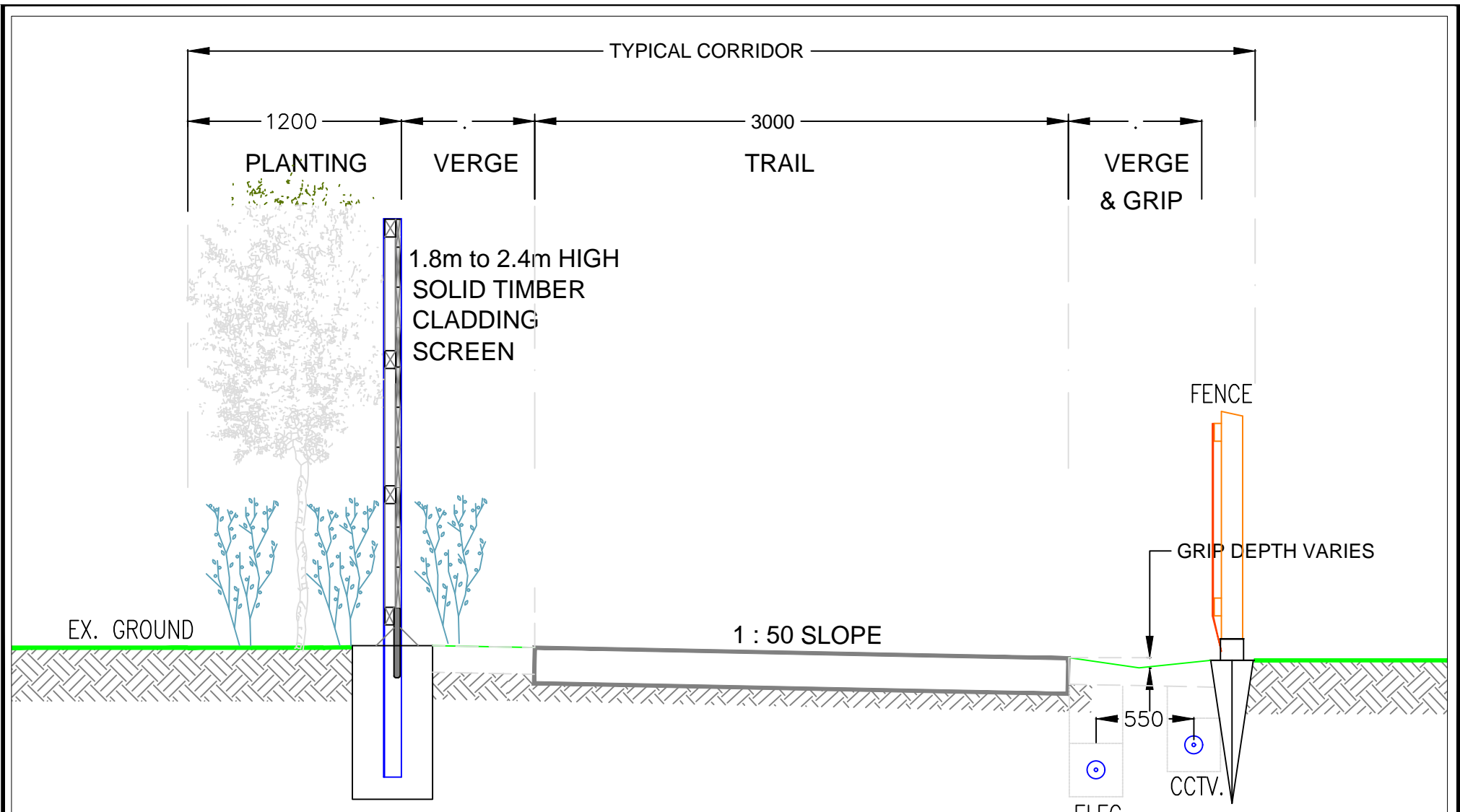

NOTE:

1. REFER TO ROUTE LAYOUT PLANS FOR LOCATION & EXTENT OF SCREEN PANELS.
2. REFER TO LANDSCAPE PLANS FOR PLANTING LOCATIONS & DETAILS.
3. REFER TO DRAINAGE PLANS FOR GRIP OUTFALL LOCATIONS.

<p>WEXFORD COUNTY COUNCIL</p>	<p>WEXFORD COUNTY COUNCIL COURT HOUSE GARRETKILN WEXFORD TEL: 053 9196500</p>	<p>DRAWING REFERENCE TCD/100/05</p>	<p>DRAWING TITLE TRAIL SCREENING (RESIDENTIAL)</p>	<p>SERIES TITLE TRAIL CROSS -SECTIONS & LAYOUTS</p>	<p>DRAWN: R O'MAHONY</p>
				<p>SCALE: DO NOT SCALE</p>	<p>CHECKED:</p> <p>DATE: JAN 2017</p>

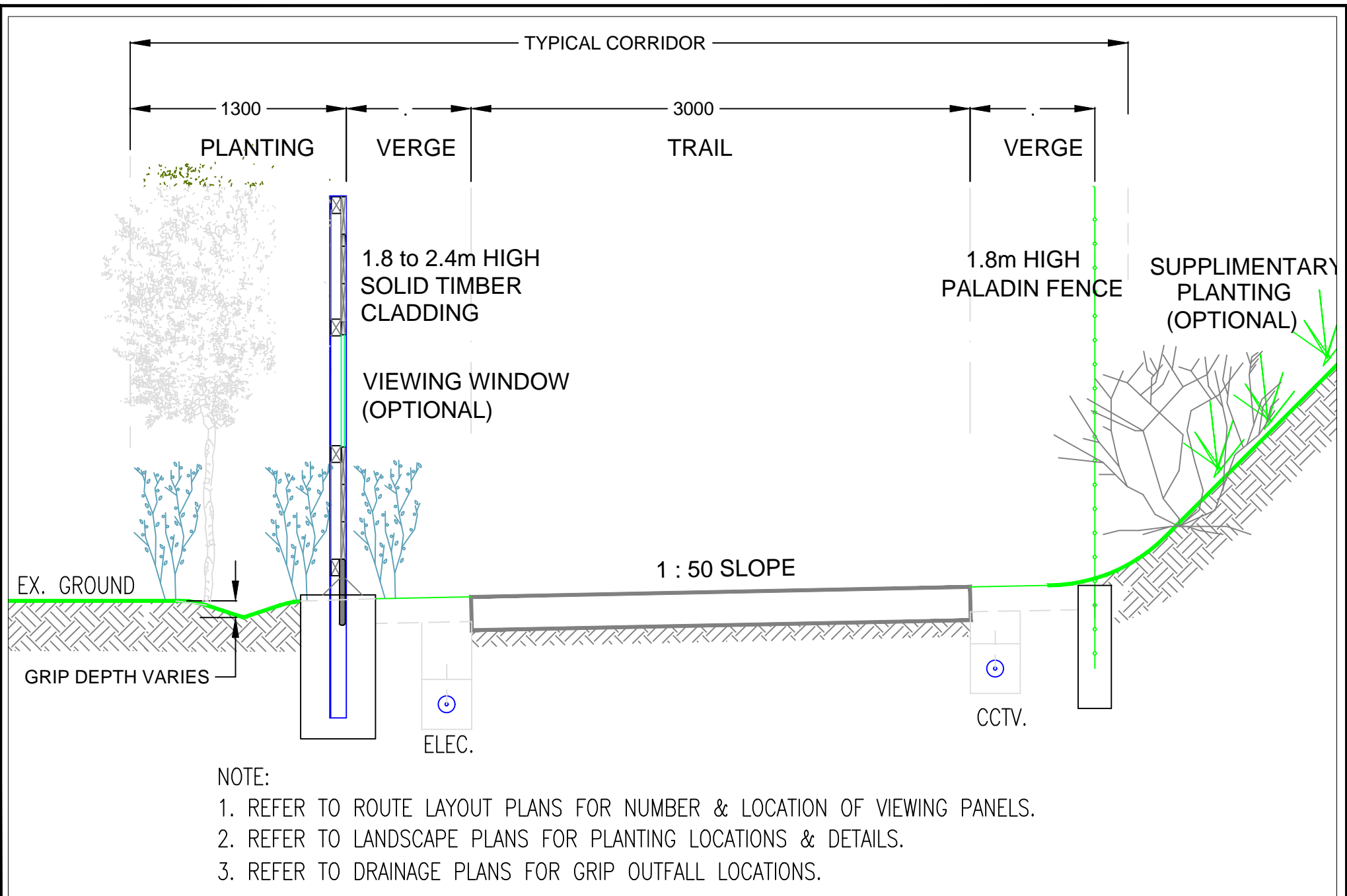

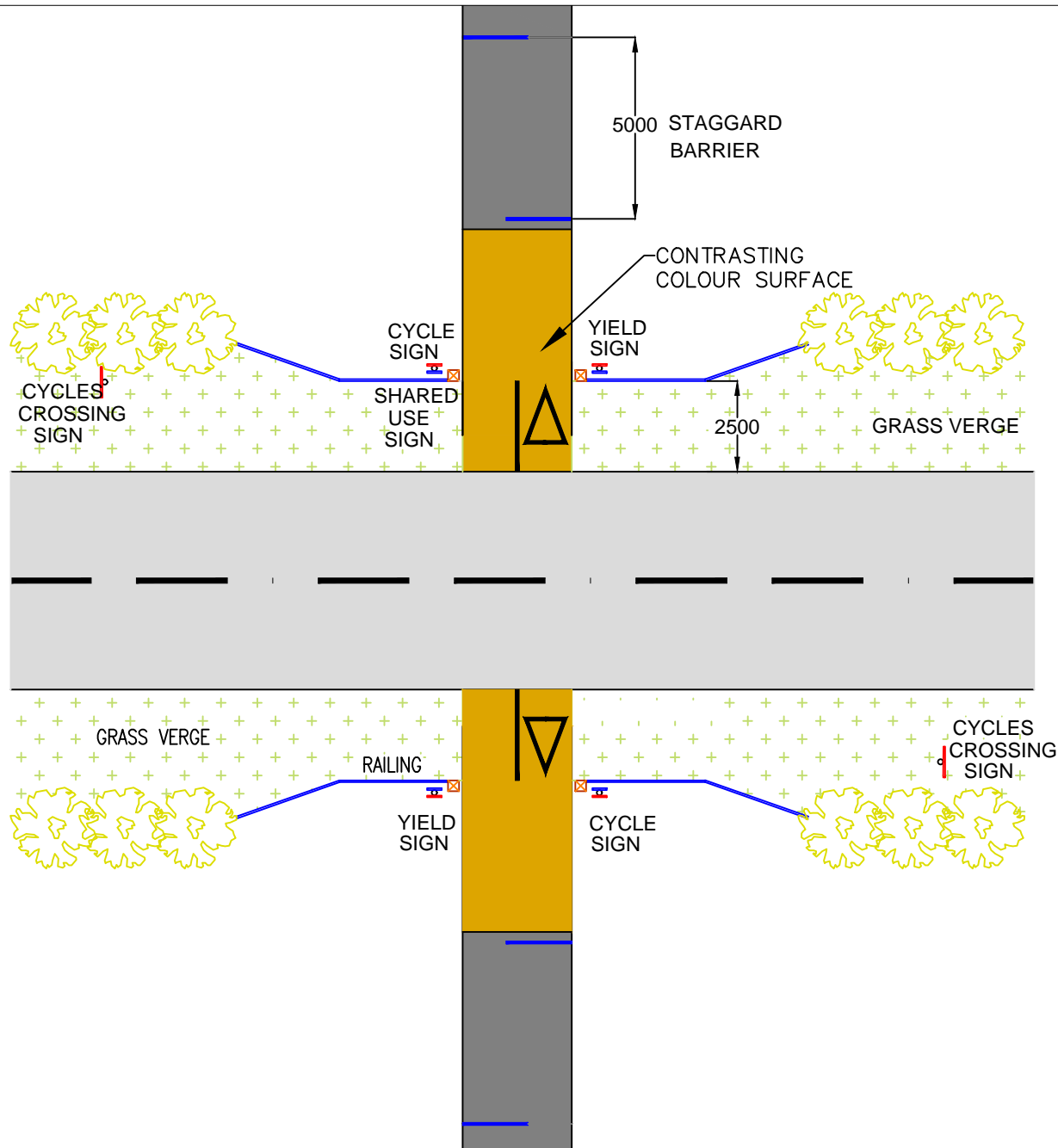

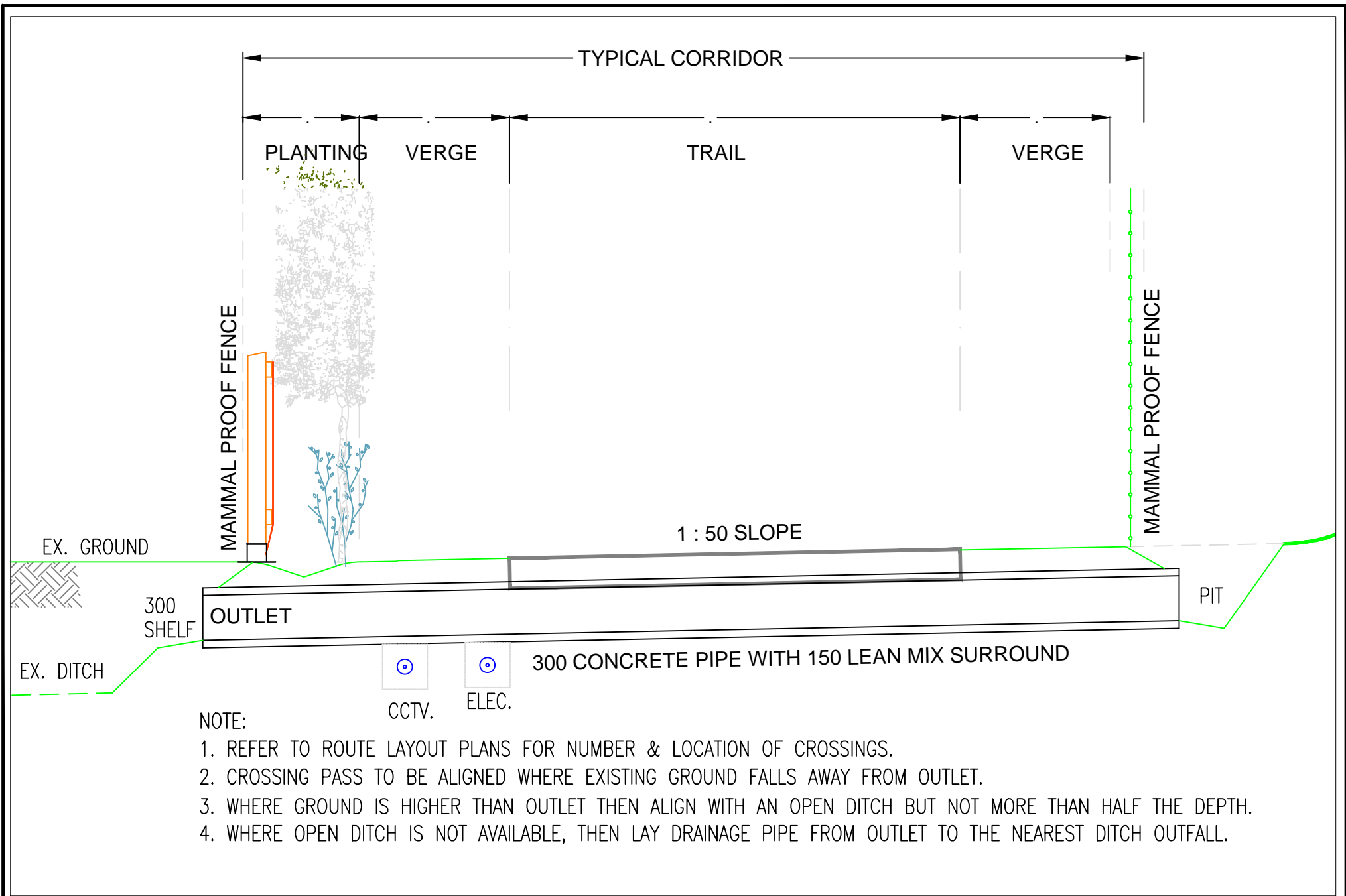

 WEXFORD COUNTY COUNCIL	WEXFORD COUNTY COUNCIL COUNTY HALL GARRIBOLLY WEXFORD TEL: 053 9196500	DRAWING REFERENCE TCD/200/05	DRAWING TITLE MAMMAL PASS	SERIES TITLE VEREG CROSS - SECTIONS	DRAWN: R O'MAHONY CHECKED: DATE: JAN 2018
					SCALE: DO NOT SCALE

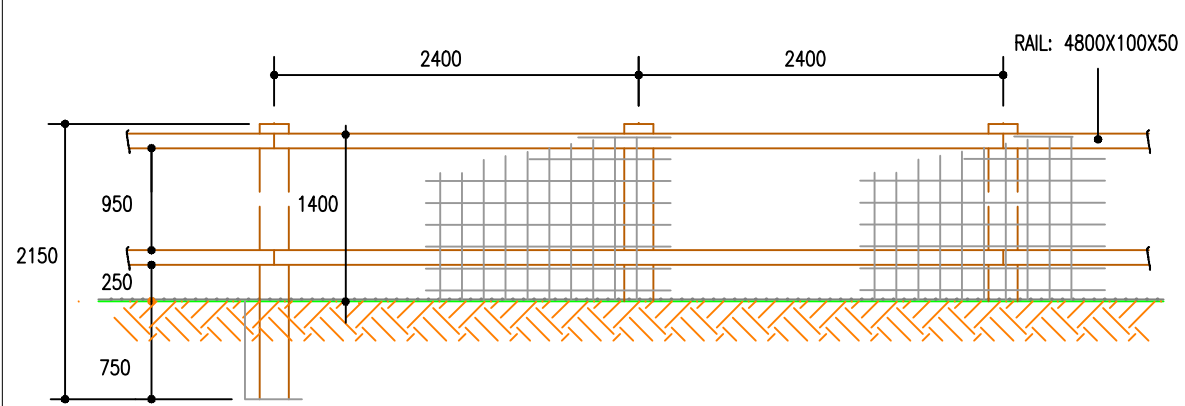

ELEVATION FIELD SIDE

POST HOLES MIN. 300X300

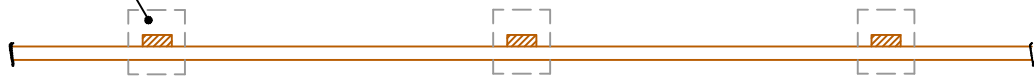

PLAN

GALV. SNARROW GAUGE WIRE 3.15mm TOP & BTM. WIRES & 2.5mm INTERMEDIATE WIRES TO FORM 200 HIGH X 150 WIDE MESH TO I.S.256 : 1986

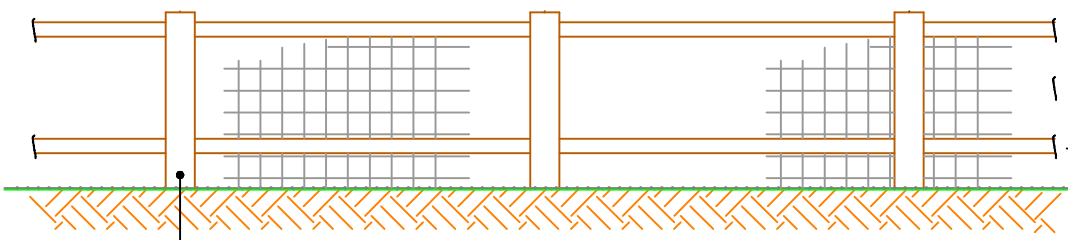

POST: 1950X150X75

ELEVATION ROAD SIDE

NAILING OF RAIL TO POST IN ACCORDANCE WITH NOTES 11 AND 12 OF I.S. 435-2:2005

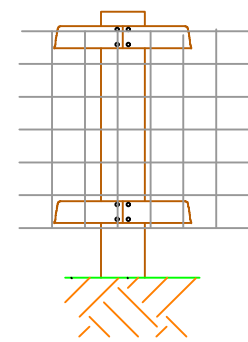

ELEVATION FIELD SIDE

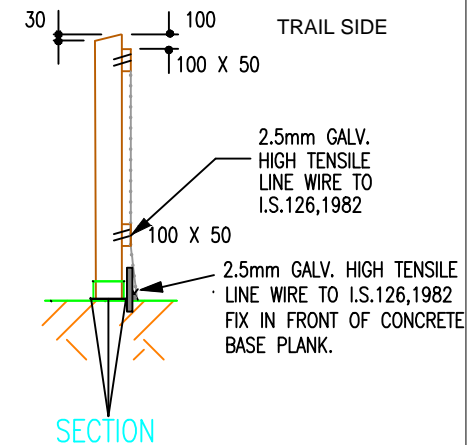

SECTION

NOTES:

1. FENCES SHALL BE CONSTRUCTED AND ERECTED IN ACCORDANCE WITH I.S. 435-1/2/3:2005.
2. ANY LENGTH OF FENCING (INCLUDING BRANCHES OR SPURS) SHALL START WITH A POST AND END WITH A POST. AN ADDITIONAL POST SHALL BE PROVIDED AT FENCE JUNCTIONS AND AT FENCE CORNERS.
3. POST HOLES FALLING IN ROCK SHALL BE EXCAVATED TO THE DEPTH SHOWN ON THE DRAWING OR, WITH THE ENGINEER'S APPROVAL, TO A DEPTH OF 500mm AND SHALL BE BACKFILLED WITH MIX ST2 CONCRETE. WHERE A REDUCED DEPTH OF HOLE IS ACCEPTED BY THE ENGINEER, THE TOP OF THE POST SHALL BE BE SUITABLY CUT AND TREATED IN ACCORDANCE WITH THE RELEVANT CREOSOTE MANUFACTURER'S INSTRUCTIONS.
4. ALL TIMBER TO BE TREATED WITH CREOSOTE IN ACCORDANCE WITH I.S.435-1:2005.
5. PLACE PRECAST CONCRETE PLANKS AT BASE OF FENCE PART BURIED BEHIND MESH WIRE WITH 25mm GAP BETWEEN PLANKS FOR RUNNOFF. THE EXTENT OF BASE PLANKS TO BE AGREED WITH ENGINEER.

FIXING OF SHEEPWIRE

1. FIX ONE STRAND OF 2.5mm DIAM. HIGH TENSILE LINE WIRE TO FIELD SIDE OF POSTS AS CLOSE TO GROUND LEVEL AS POSSIBLE.
2. SECURE WIRE MESH TO FIELD SIDE OF RAILS WITH 4 STAPLES PER LINEAR METRE ON THE TOP RAIL AND 1 STAPLE PER LINEAR METRE ON OTHER RAILS. SECURE TO LINE WIRE WITH 2mm DIAM. MILD STEEL TYING WIRE AT 4 TIES PER METRE. LINE WIRE AND TYING WIRE TO I.S.126. WIRE STAPLES SHALL BE GALV. 30mm X 3.55mm ROUND WIRE TO I.S.105.

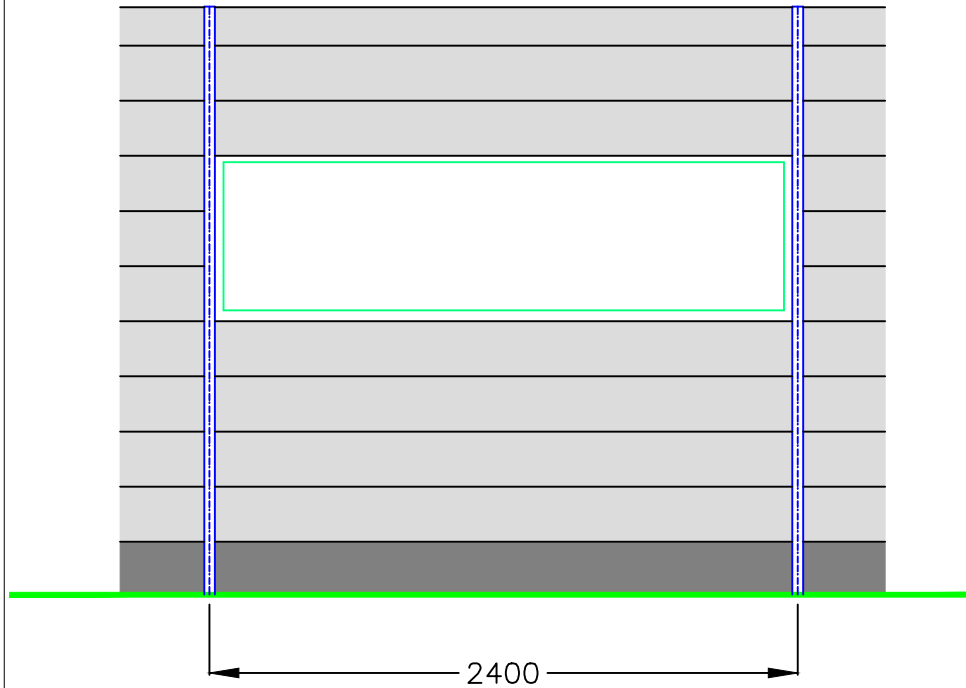

ELEVATION

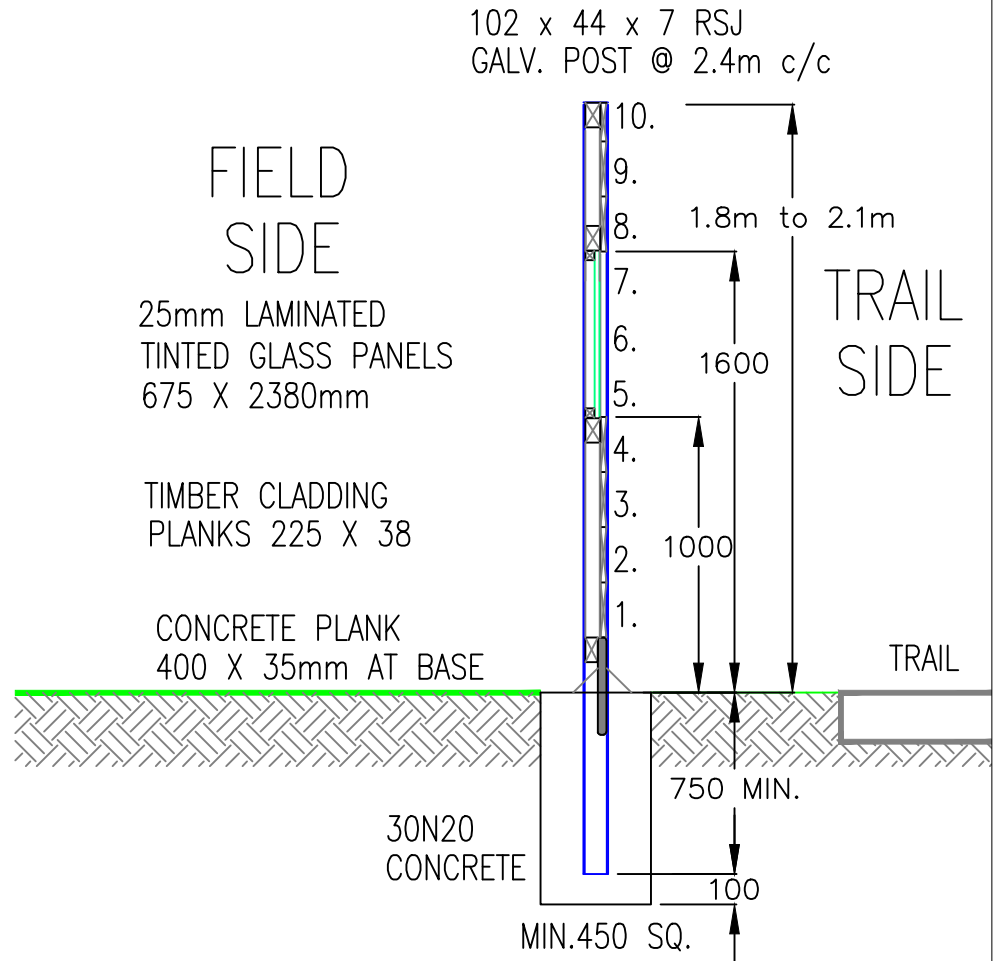

NOTE:

1. REFER TO ROUTE LAYOUT PLANS FOR NUMBER, LOCATION & HEIGHT OF SCREEN PANELS.
2. THE EXACT LOCATION OF EACH VIEWING PANELS TO BE AGREED WITH THE ENGINEER.
3. ALL METAL SHALL BE GALVANISED TO B.S. 729.
4. ALL TIMBER TO BE TREATED IN ACCORDANCE WITH IS 435-2005.
5. ALL CONCRETE PLANKS TO BE BACK HAUNCHED WITH CONCRETE.

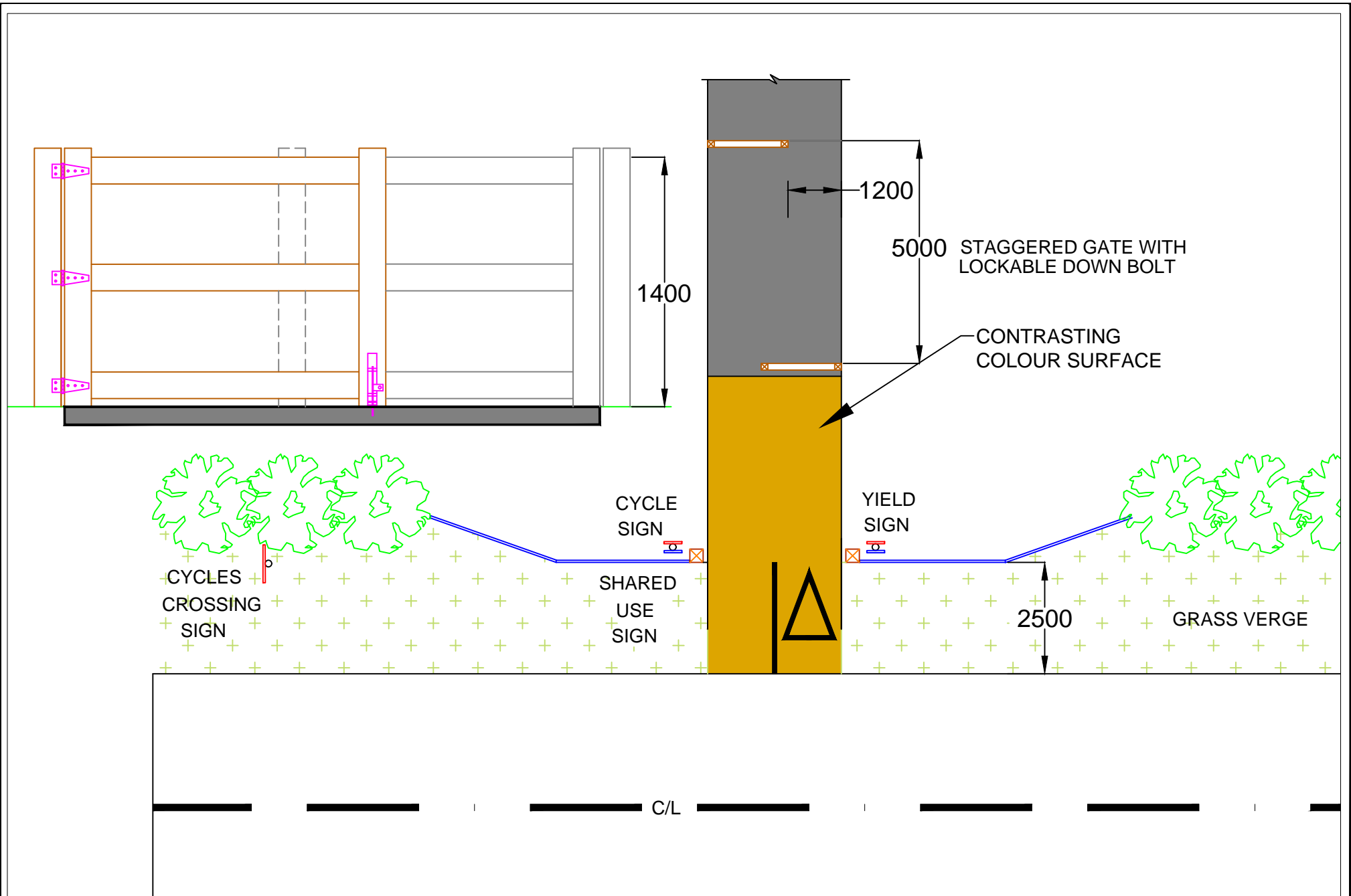

102 x 44 x 7 RSJ
 GALV. POST @ 3.1m c/c

PALADIN FENCE

**FIELD
 SIDE**

**TRAIL
 SIDE**

1.8m to 2.1m

TRAIL

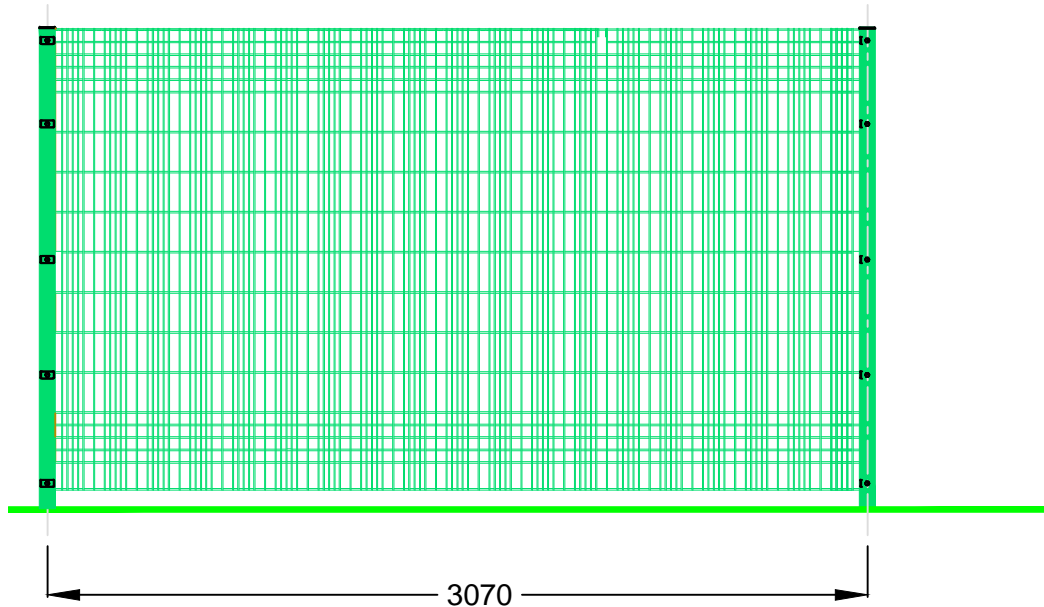

3070

ELEVATION

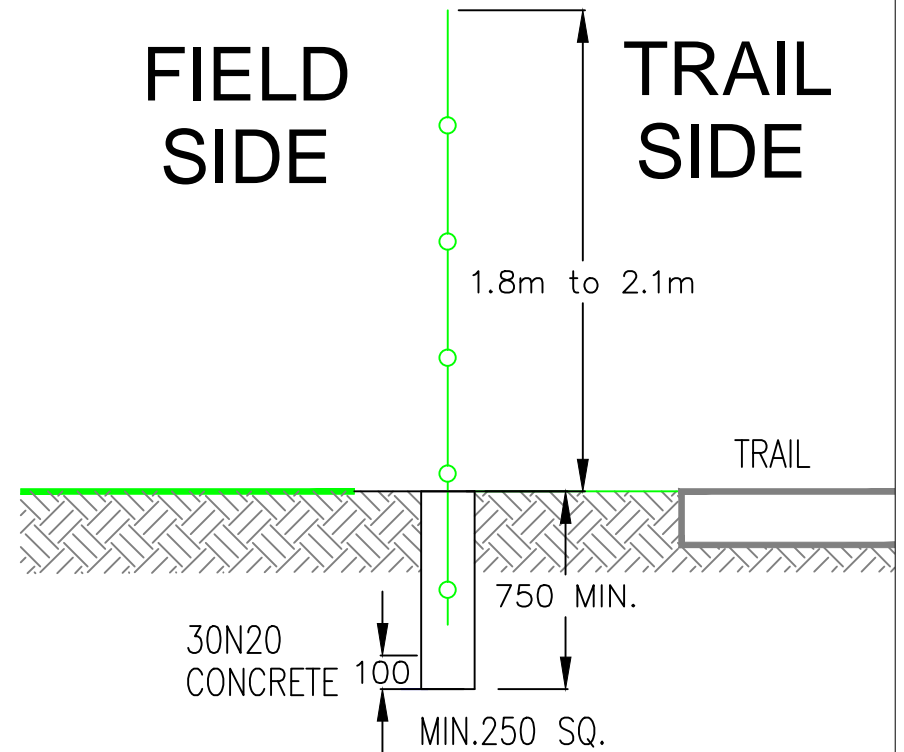

30N20
 CONCRETE

100

750 MIN.

MIN.250 SQ.

NOTE:

1. REFER TO ROUTE LAYOUT PLANS FOR NUMBER, LOCATION & HEIGHT OF PANELS.
2. ALL METAL SHALL BE GALVANISED TO B.S. 729.



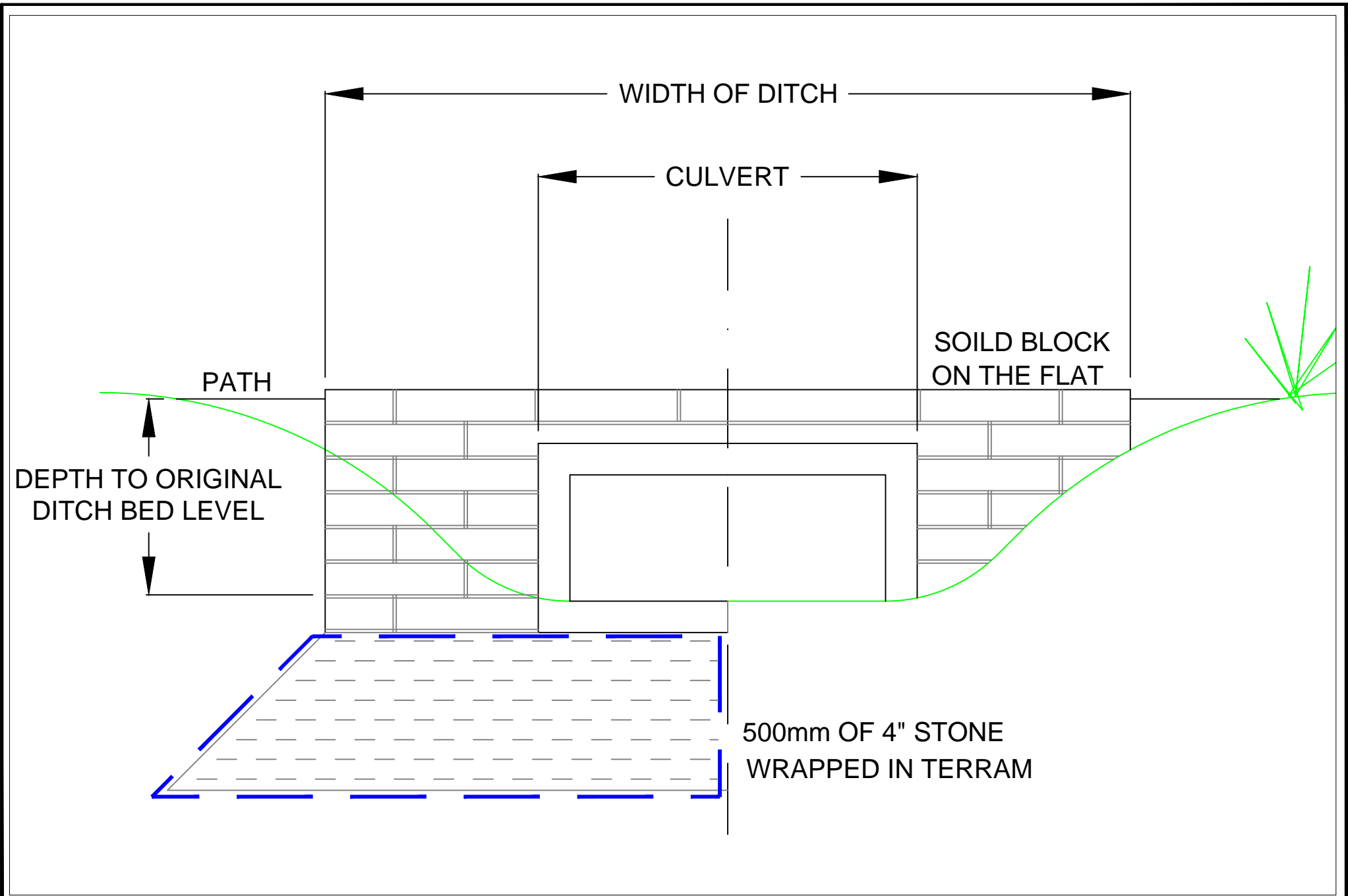

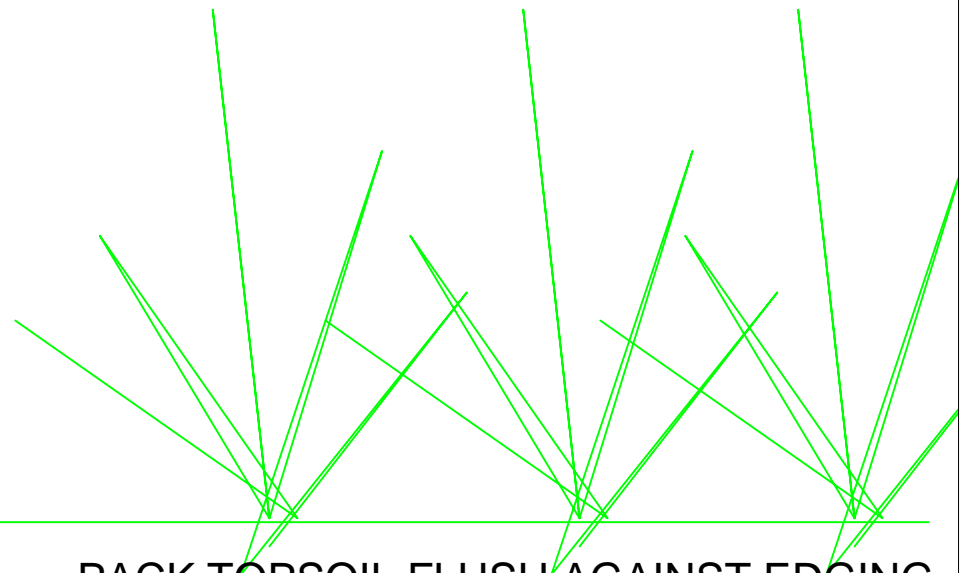
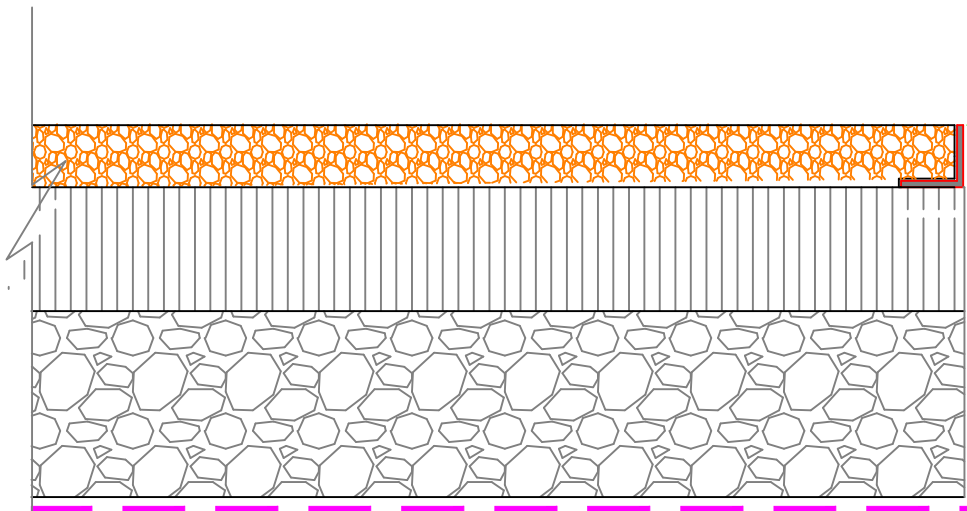

PACK TOPSOIL FLUSH AGAINST EDGING

50x50 GALVANISED ANGLE EDGING
OR 50 X 100 PRECAST KERB
FLUSH WITH PAVEMENT.

50mm MACADAM PAVEMENT ON
100mm CI.804 MATERIAL, WELL COMPACTED ON
150mm SUB-BASE 50mm STONE MATERIAL.
WRAPPED IN TERRAM GEOTEXTILE WHERE
BY THE ENGINEER.

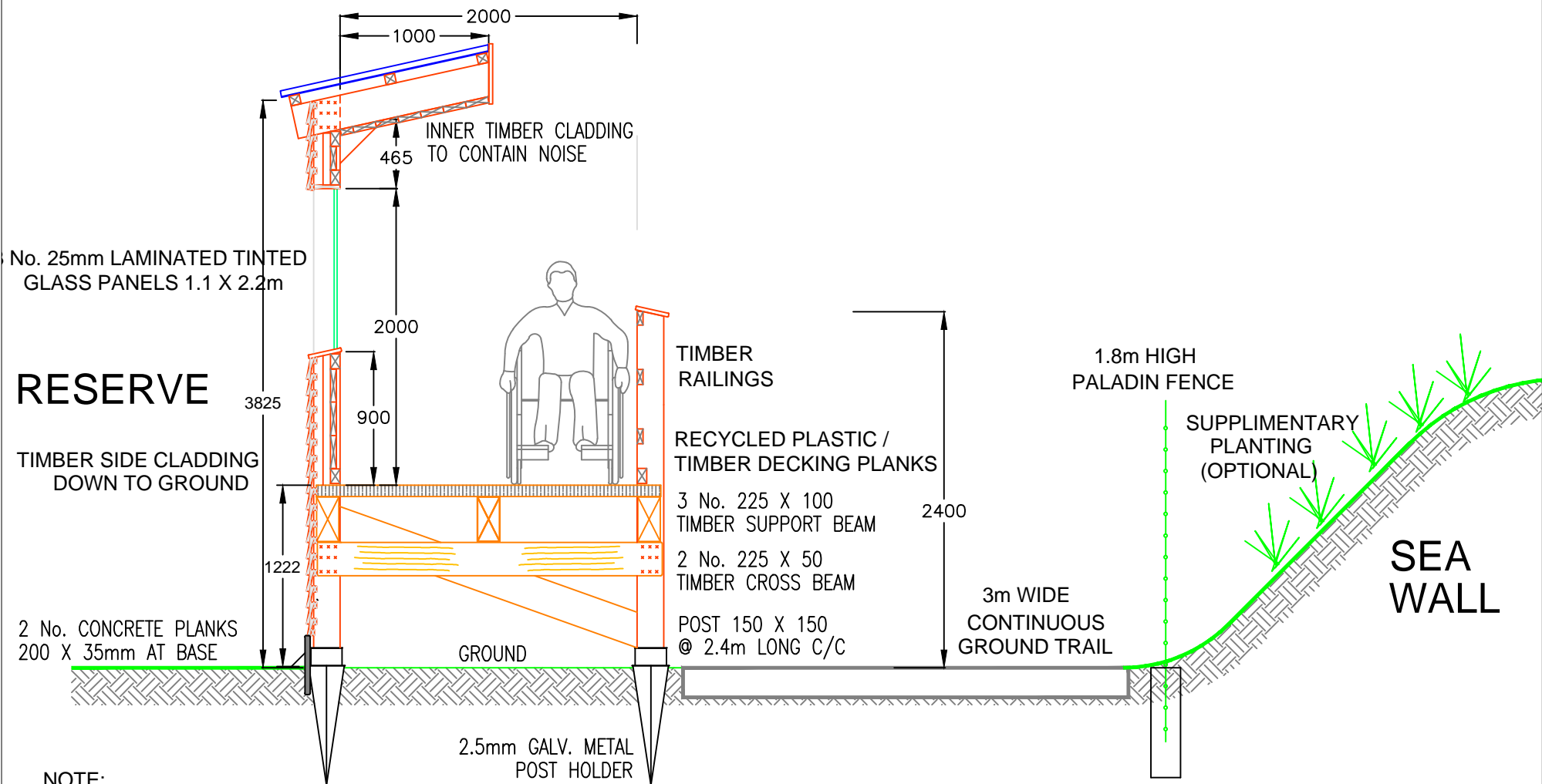

NOTE:

1. REFER TO ROUTE LAYOUT PLANS FOR NUMBER & LOCATIONS OF VIEWING POINTS.
2. REFER TO TCD/1000/04 FOR ELEVATION DETAILS.
3. FIX HORZ. TIMBER DIAGONAL BRACING TO SUPPORT BEAMS.
4. FIX VERT. TIMBER DIAGONAL BRACING TO SUPPORT POSTS.
5. ALL CONCRETE PLANKS TO BE BACK HAUNCHED WITH CONCRETE.
6. ALL METAL SHALL BE GALVANISED TO B.S. 729.
7. ALL TIMBER SHALL BE TREATED IN ACCORDANCE WITH I.S. 435-2005.

<p>WEXFORD COUNTY COUNCIL</p>	<p>WEXFORD COUNTY COUNCIL COUNTY HALL, GARIBOLDLAWN, WEXFORD. TEL: 053 9195500</p>	<p>DRAWING REFERENCE</p> <p>TCD/1000/03</p>	<p>DRAWING TITLE</p> <p>RAISED DECK VIEWING PLATFORM</p>	<p>SERIES TITLE</p> <p>BOARDWALKS</p>	<p>DRAWN: R O'MAHONY</p>
				<p>SCALE: DO NOT SCALE</p>	<p>CHECKED:</p> <p>DATE: JAN 2017</p>

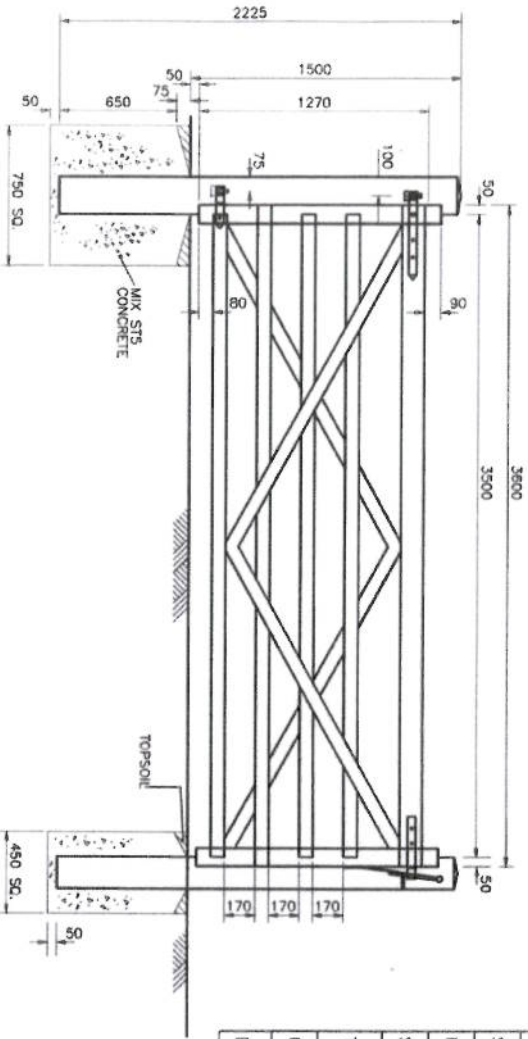

DESCRIPTION OF TIMBER MATERIALS	SIZE
HANGING POST	200X200X2225 LONG
SHUTTling POST	175X175X2225 LONG
HANGING STILE	100X100
SHUTTling STILE	100X100
TOP RAIL	100X125
UNDER RAILS	75X38
BRACES HOUSED IN TOP RAIL	75X25

NOTES :

1. ALL DIMENSIONS ARE IN MILLIMETRES UNLESS OTHERWISE STATED.
2. GATES SHALL COMPLY WITH THE APPROPRIATE CLAUSES IN THE 300 SERIES AND ANY FURTHER REQUIREMENTS IN APPENDIX 1/15 OR 3/1.
3. ALL THROUGH TENONS SHALL BE PEGGED WITH 13 DIA. OAK DOWELS.
4. FOR DETAILS OF FITTINGS FOR HANGING AND FASTENING SEE RCD/300/13 AND RCD/300/14.
5. THE GATE SHALL BE HUNG AS SHOWN FOR SELF CLOSING WITH SELF LATCHING STOP POST AS SHOWN ON RCD/300/14.
6. THE GATE SHALL OPEN INWARD FROM THE ADJACENT CARRIAGEWAY INTO THE OWNER'S PROPERTY.
7. TIMBER TO BE TREATED IN ACCORDANCE WITH IS 435.

SCALE 1:1000

Issue	Date
P2	01/07
P1	03/00

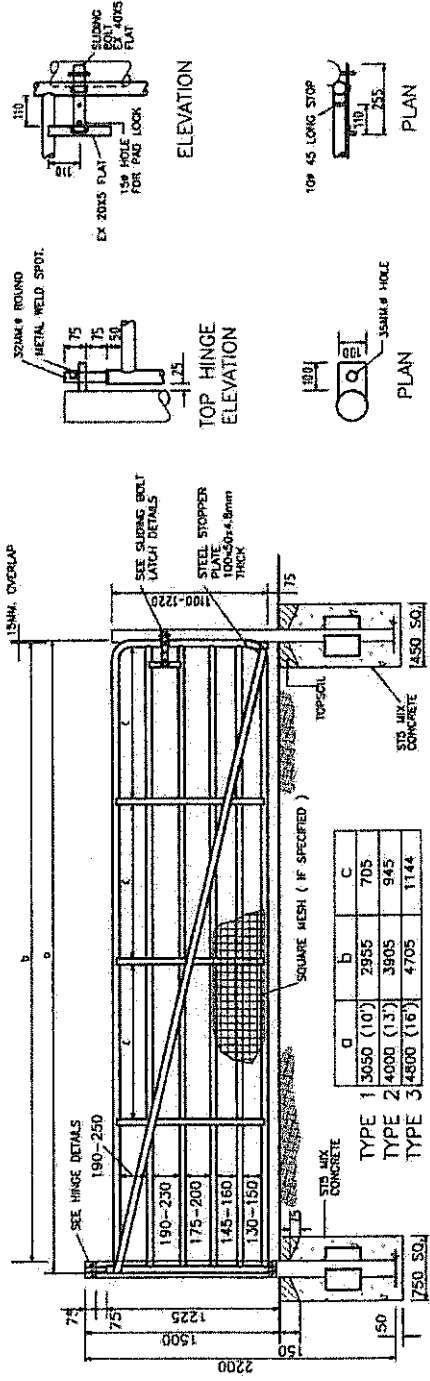

	a	b	c
TYPE 1	3650 (10)	2955	705
TYPE 2	4000 (13)	3905	945
TYPE 3	4800 (16)	4705	1144

MATERIAL DESCRIPTION	SIZE	FIXINGS
HANGING POST (TUBULAR STEEL)	114.3mm EXT. DIA. 3.6mm THICK	CAP PLATES 4.8mm THICK. BASE PLATES 250X250X4.8mm THICK. CAP & BASE PLATES TO BE CONTIGUOUSLY FLUSH WELDED TO TUBES.
SHAPING POST (TUBULAR STEEL)	98.8mm EXT. DIA. 3.2mm THICK	WING PLATES 250X250X4.8mm THICK STITCH WELDED TO POST.
MAIN FRAME (TUBULAR STEEL)	48.3mm EXT. DIA. 2.9mm THICK	---
INFILLING HORIZONTAL RAILS (TUBULAR STEEL)	42.4mm EXT. DIA. 2.6mm THICK	---
BRACES (FLAT STEEL) 3 VERTICAL, 2 DIAGONAL	38X4.8mm	FILLET WELDED TO EACH GATE MEMBER. CROSSED BY BRACES
MESH FABRIC (IF SPECIFIED)	51mm SQ. X 4.1mm ^Ø STEEL SQUARE WELDED MESH FABRIC.	---

- NOTES:
1. ALL DIMENSIONS ARE IN MILLIMETRES.
 2. THE FINISHES ARE TO BE AS SPECIFIED IN THE CONTRACT DOCUMENTS AND ANY FURTHER REQUIREMENTS IN APPENDIX 1/15 OR 3/1.
 3. GATES SHALL OPEN INWARD FROM THE ADJACENT CARRIAGEWAY INTO THE OWNER'S PROPERTY.
 4. HINGES AND LATCH AS DETAIL.
 5. THE DIMENSIONS OF THE MAIN FRAME MAY BE DIMINISHED OR INCREASED.
 6. GATES & FITTINGS SHALL BE GALVANIZED TO COMPLY WITH IS EN 10240 UNLESS ALTERNATIVE PROTECTIVE TREATMENT DESCRIBED IN APPENDIX 1/15 OR 3/1.
 7. GATE STOPS TO BE PROVIDED IN ACCORDANCE WITH RCD/366/14.

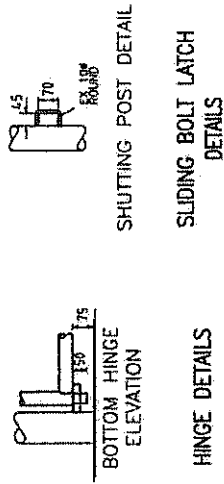

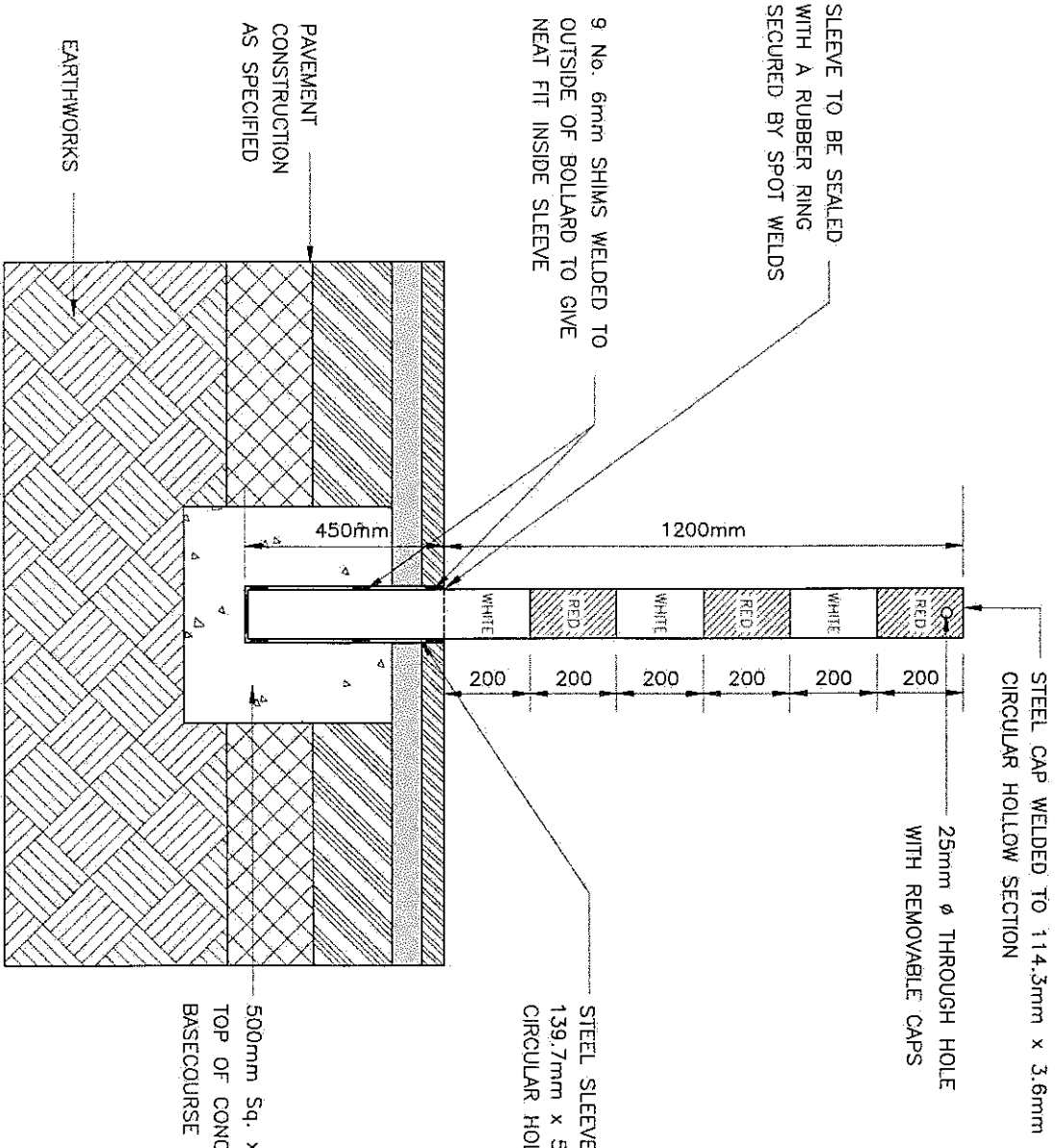

STEEL CAP WELDED TO 114.3mm x 3.6mm CIRCULAR HOLLOW SECTION

25mm ϕ THROUGH HOLE WITH REMOVABLE CAPS

STEEL SLEEVE 139.7mm x 5.0mm CIRCULAR HOLLOW SECTION

500mm Sq. x 500mm DEEP ST4 CONCRETE. TOP OF CONCRETE FINISHED AT UNDERSIDE OF BASECOURSE LAYER

NOTES :

1. BOLLARDS AND SLEEVES TO BE GALVANISED TO BS 729.
2. BOLLARDS TO BE PAINTED RED AND WHITE.

Issue	Date
P1	03/00